

## MAFU Drum Basic Unit with Removable Drum

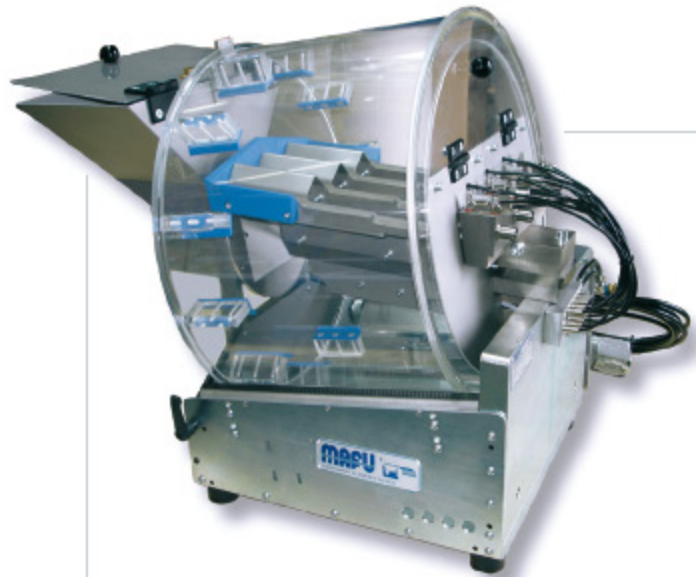

The MAFU Drum is a disentangling unit that allows the gentle and efficient disentangling and separation of small parts, for example, springs, pins, bent-wire parts, and similar, from goods delivered in bulk.

Based on technical principles, the MAFU Drum has many feeding, separation and presentation variations that can be combined in ways that will satisfy the diverse and specific requirements of our customers.

In this way, for example, depending on the desired feeding performance, part size and geometry, a feeding system with up to 43 tracks can be realised, and separation as well as presentation can be adapted to the desired level of automation.

### The MAFU Drum offers the following advantages:

#### **Flexibility:**

Owing to the underlying technical principle and available upgrade options such as diverse testing, stocking, and separation systems, the MAFU Drum accommodates a multitude of requirements and parts.

#### **Cost effectiveness:**

Its high conveyance performance, the high level of automation that is possible, as well as its low energy consumption and wear make the MAFU Drum a highly economical solution.

#### **Quality:**

Based on its minimal vibration (90% less vibration in comparison with a spiral conveyor), parts can be gently disentangled and fed, thus enabling processing of sensitive parts as well.

#### **Easy operation / Ergonomic design:**

Even without noise insulation, the MAFU Drum operates quietly, and owing to its size, does not require much space, thereby allowing installation anywhere. Furthermore, owing to its well thought-out design, the drum can be quickly and simply dismantled for emptying.

### **Fields of Application:**

#### **Disentangling Technology:**

Disentangling and positional alignment of small parts delivered as bulk goods - for example, springs, pins, bent-wire parts, and similar.

#### **Feeding Technology:**

Feeding, separation, and presentation of bulk goods with corresponding additional features, which are adapted to the geometry of the parts.

#### **Sectors:**

##### **Machining industry, automobile industry and its suppliers:**

Disentangling, separation, and feeding of parts such as valve springs, brake clips, transmission thrust pads, and much more for assembly.

##### **Electrical, electronics, and plastics industries:**

Disentangling, separation, and feeding of parts such as cable terminals, springs, plastic parts, and much more for assembly.

##### **Medical, pharmaceutical, and cosmetics industries:**

Disentangling, separation, and feeding of parts such as springs, pins, plastic parts, and much more for assembly.

The MAFU Drum can be employed in a multitude of additional sectors and areas of manufacturing and is able, through the implementation of MAFU's clever systems solutions, to undertake the most varied tasks. There are practically no set boundaries.

# MAFU Drum Basic Unit with Removable Drum

## Method of functioning:

Bulk goods are fed via a hopper into the drum and by means of the drum's rotational motion are then gently disentangled and brought onto a feed rail. The linear motion of the feed rail and its special baffles align the parts into the desired position before they are separated and presented. The number and type of feeds and separations are individually adapted to the geometry of the parts and the specific requirements of the customer.



## Presentation solutions dependent on part geometry:

### Feeding through tubes:

Small parts, for example, springs, pins, sleeves, and all parts whose geometric form allows an end-to-end ordering in and through a feeding tube.

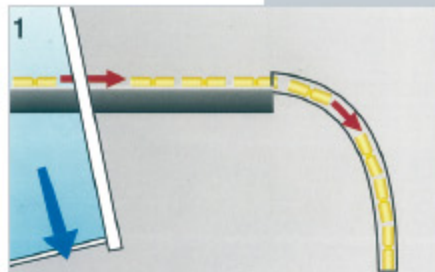

### Threading on rails:

Small parts, for example, circlips, wire snap rings, and various bent-wire parts whose geometric form allows threading on a rail.

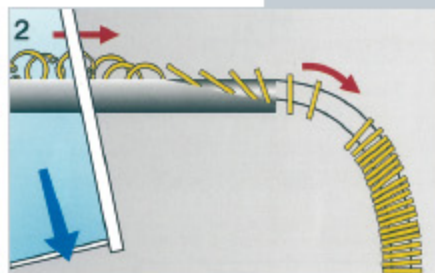

### Hanging:

Small parts, for example, screws, rivets, nails, and other parts whose geometric form and centre of gravity allow hanging.

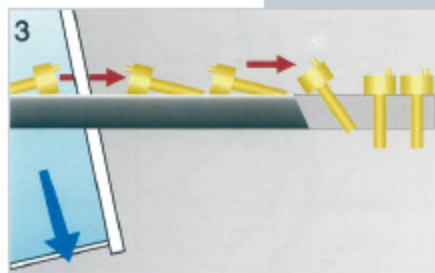

# MAFU

MAFU GmbH  
Daimlerstraße 7  
D-72348 Rosenfeld  
Tel. +49 (0) 74 28 / 9 31-0  
Fax +49 (0) 74 28 / 9 31-400  
e-mail: [info@mafu.de](mailto:info@mafu.de)  
Internet: [www.mafu.de](http://www.mafu.de)